

Download File PDF Btm10 Jensen User Guide

#Jenny



Finally I get this ebook, thanks for all these I can get now!

#Rio



Cool! I'am really happy

#Markus Jensen



I did not think that this would work, my best friend showed me this website, and it does! I get my most wanted eBook

#Hun Tsu



wtf this great ebook for free?!

#Che Salsa



My friends are so mad that they do not know how I have all the high quality ebook which they do not!

#Diego Butler



so many fake sites. this is the first one which worked! Many thanks

Optional Equipment

- **NAV20:** Allows you to access navigation features. All installation and operating instructions are included with the navigation module.
- **BTM10:** Allows you to connect to a Bluetooth enabled cell phone or other device.
- **Rear Camera:**

Disconnecting the Battery

To prevent a short circuit, be sure to turn off the ignition and remove the negative (-) battery cable prior to installation.

NOTE: If the VM9214 is to be installed in a car equipped with an on-board drive or navigation computer, do not disconnect the battery cable. If the cable is disconnected, the computer memory may be lost. Under these conditions, use extra caution during installation to avoid causing a short circuit.

Pre-installation

1 Remove the four screws that attach the mounting sleeve to the radio and remove the sleeve.

2 Install the mounting sleeve.

- Install mounting sleeve into the dashboard or optional adapter. Do not force the sleeve into the opening or cause it to bend or break.
- Locate the series of bend tabs along the top, bottom and sides of the mounting sleeve. With the sleeve fully inserted into the dashboard opening, bend as many of the tabs outward as necessary so that the sleeve is firmly secured to the dashboard.
- Install support strap to make the unit more stable.

3 Place the radio in front of the dashboard opening so the wiring can be brought through the mounting sleeve.

CAUTION! Be careful not to damage the car wiring.

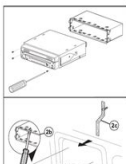

[Download PDF version of :](#)
Btm10 Jensen User Guide